

\$409,542 - 173 Ridgeway Cir, CRESTVIEW

MLS® #957448

\$409,542

5 Bedroom, 4.00 Bathroom, 3,030 sqft
Detached Single Family on 0.00 Acres

Ridgeway Landing, CRESTVIEW, FL

This 3030 square foot home is by far one of our most loved plans! It offers 5 bedrooms, a loft, large bonus room and 3 and a half bathrooms. Lots of space for family, friends and entertaining. This 4-sided brick home is being built in North Crestview within close proximity to shopping, restaurants and schools. Comes with a fully finished automatic 2 car garage, irrigation, termite bonds, fully sodded yard and a professional landscaping package! Some upgrades that are being added to this home include craftsman style elevation, quartz countertops in kitchen and bathrooms, upgraded flooring with carpet only in the bedrooms and stairs and a separate walk-in shower and garden tub in the master bathroom! Oh, and did I mention the LARGE master bedroom closet! This home is a must see.

Built in 2025

Essential Information

MLS® #	957448
Price	\$409,542
Bedrooms	5
Bathrooms	4.00
Full Baths	3
Half Baths	1
Square Footage	3,030
Acres	0.00

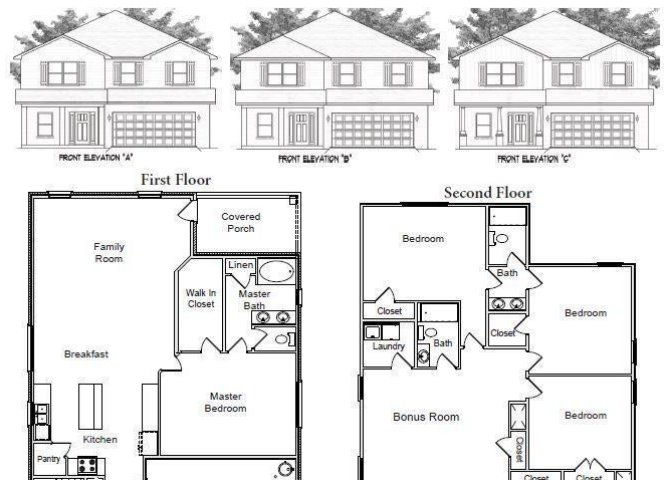

Year Built	2025
Type	Detached Single Family
Sub-Type	Detached Single Family
Style	Craftsman Style
Status	Active

Community Information

Address	173 Ridgeway Cir
Area	Crestview Area
Subdivision	Ridgeway Landing
City	CRESTVIEW
County	OKALOOSA
State	FL
Zip Code	32536

Amenities

Amenities	Pool
Utilities	Electric Available, Public Sewer Available, Underground
Parking Spaces	2
Parking	Garage: Attached
# of Garages	2
Has Pool	Yes
Pool	Community, Private

Interior

Interior Features	Floor Vinyl, Kitchen Island, Lighting Recessed, Pantry, Split Bedroom, Washer/Dryer Hookup, Newly Painted, Pull Down Stairs
Appliances	Auto Garage Door Opn, Dishwasher, Disposal, Microwave, Oven:Self Cleaning, Smoke Detector, Stove/Oven Electric, Warranty Provided
Heating	Heat: Central Electric
Cooling	A/C: Central Electric, Ceiling Fans
# of Stories	2

Exterior

Exterior	Siding Brick All, Roof Dimensional Shingle, Foundation Slab On Grade, Trim Vinyl
Exterior Features	Patio Covered, Porch Covered, Sprinkler System, Columns
Lot Description	Covenants, Level, Sidewalk
Roof	Roof Dimensional Shingle

Foundation Foundation Slab On Grade

School Information

Elementary BOB SIKES
Middle DAVIDSON
High CRESTVIEW

Additional Information

Zoning City
HOA Fees 400.00
HOA Fees Freq. Annually

Listing Details

Listing Office Adams Homes Realty Inc

DISCLAIMER: Information Deemed Reliable but not guaranteed. The information being provided is for consumers' personal, non-commercial use and may not be used for any purpose other than to identify prospective properties consumers may be interested in purchasing. All listings are provided courtesy of the Emerald Coast Association of Realtors, Copyright 2024, All rights reserved. Vendors Member Number : 28325
Listing information last updated on August 21st, 2024 at 9:15pm CDT