

# \$327,913 - 327 Keswick Ln, CRESTVIEW

MLS® #957444

## \$327,913

3 Bedroom, 2.00 Bathroom, 1,727 sqft  
Detached Single Family on 0.00 Acres

Ridgeway Landing Phase 2, CRESTVIEW, FL

Looking for a home that has it all? Come see this wonderfully planned 3/2 with upgrades and standard features that will make you want to call this one home. The front offers a covered porch as well as the back. The home is 4 sided brick and comes with sprinklers, fully sodded and landscaped. The craftsman style elevation gives it great curb appeal. You'll find shaker cabinets in the kitchen and bathrooms as well as granite countertops. The floors are upgraded Puretec with carpet in bedrooms only. The master bath has dual vanities and a separate walk in shower with a garden tub. Formal areas have bull nosed corners and all baseboards are 5 1/4'. This house comes with a 10 yr. Bonded Builders Warranty. The community pool is a plus on those hot summer days!

Built in 2024

### Essential Information

MLS® #	957444
Price	\$327,913
Bedrooms	3
Bathrooms	2.00
Full Baths	2
Square Footage	1,727
Acres	0.00
Year Built	2024
Type	Detached Single Family

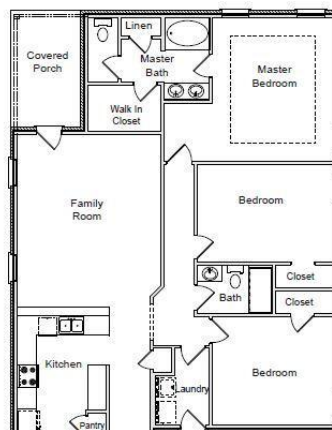

Sub-Type	Detached Single Family
Style	Craftsman Style
Status	Active

### Community Information

Address	327 Keswick Ln
Area	Crestview Area
Subdivision	Ridgeway Landing Phase 2
City	CRESTVIEW
County	OKALOOSA
State	FL
Zip Code	32536

### Amenities

Amenities	Pool
Utilities	Electric Available, Public Sewer Available, Public Water Available
Parking Spaces	2
Parking	Garage: Attached
# of Garages	2
Has Pool	Yes
Pool	Community

### Interior

Interior Features	Breakfast Bar, Ceiling Tray/Cofferd, Floor Vinyl, Floor WW Carpet New, Lighting Recessed, Pantry, Pull Down Stairs, Washer/Dryer Hookup
Appliances	Auto Garage Door Opn, Dishwasher, Microwave, Oven:Self Cleaning, Smoke Detector, Smooth Stovetop Rnge, Stove/Oven Electric, Warranty Provided
Heating	Heat: Central Electric
Cooling	A/C: Central Electric, Ceiling Fans
# of Stories	1

### Exterior

Exterior	Siding Brick All, Roof Dimensional Shingle, Foundation Slab On Grade, Trim Vinyl
Exterior Features	Patio Covered, Sprinkler System
Lot Description	Interior, Level, Survey Available
Windows	Double Paned Windows
Roof	Roof Dimensional Shingle

Foundation                      Foundation Slab On Grade

### **School Information**

Elementary                      BOB SIKES  
Middle                              DAVIDSON  
High                                  CRESTVIEW

### **Additional Information**

Zoning                              City, Residential Single Family  
HOA Fees                              400.00  
HOA Fees Freq.                      Annually

### **Listing Details**

Listing Office                      Adams Homes Realty Inc

DISCLAIMER: Information Deemed Reliable but not guaranteed. The information being provided is for consumers' personal, non-commercial use and may not be used for any purpose other than to identify prospective properties consumers may be interested in purchasing. All listings are provided courtesy of the Emerald Coast Association of Realtors, Copyright 2024, All rights reserved. Vendors Member Number : 28325  
Listing information last updated on August 21st, 2024 at 7:15pm CDT