

\$534,900 - 9250 Ridge Dr, NAVARRE

MLS® #955371

\$534,900

5 Bedroom, 3.00 Bathroom, 2,236 sqft
Detached Single Family on 0.57 Acres

NONESUCH WAY, NAVARRE, FL

TO BE BUILT!! All brick 5 Bedroom, 3 full Baths, 2236 square foot home in East Navarre. No HOA. This split floor plan home features a spacious great room, dining area and a large kitchen with granite counter tops, soft close cabinet drawers, tile backsplash, smooth top stove, built-in microwave and dishwasher. The home has luxury vinyl plank floors through out the home. The Master Suite features: a large tiled shower, garden tub, double granite vanity, luxury vinyl plank and a large walk-in closet.. There is a 11x17 covered porch on the back of this home. Landscaping: sodded, in-ground sprinkler system with well.

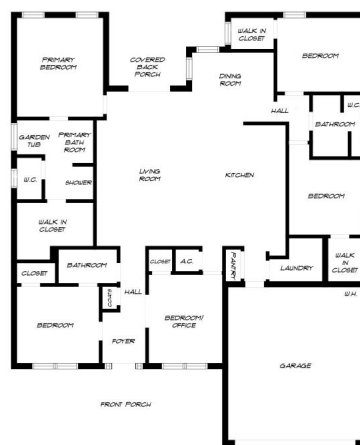

Built in 2024

Essential Information

MLS® #	955371
Price	\$534,900
Bedrooms	5
Bathrooms	3.00
Full Baths	3
Square Footage	2,236
Acres	0.57
Year Built	2024
Type	Detached Single Family
Sub-Type	Detached Single Family
Style	Craftsman Style
Status	Active

Community Information



Address	9250 Ridge Dr
Area	Navarre/Gulf Breeze
Subdivision	NONESUCH WAY
City	NAVARRE
County	SANTA ROSA
State	FL
Zip Code	32566

Amenities

Utilities	Electric Available, Public Sewer Available, Public Water Available
Parking Spaces	2
Parking	Garage: Attached
# of Garages	2
Pool	Community, Private

Interior

Interior Features	Ceiling Tray/Cofferd, Floor Laminate, Kitchen Island, Newly Painted, Pantry, Split Bedroom, Washer/Dryer Hookup, Pull Down Stairs, Shelving
Appliances	Auto Garage Door Opn, Dishwasher, Disposal, Microwave, Smooth Stovetop Rnge, Stove/Oven Electric, Smoke Detector, Warranty Provided
Heating	Heat: Central Electric
Cooling	A/C: Central Electric, Ceiling Fans
# of Stories	1

Exterior

Exterior	Siding Brick All, Roof Dimensional Shingle, Siding Brick Some, Foundation Slab On Grade, Trim Vinyl, Frame, Siding CmntFbrHrdBrd
Exterior Features	Lawn Pump, Patio Covered, Porch Covered, Sprinkler System, Hurricane Shutters
Lot Description	Interior
Windows	Double Paned Windows
Roof	Roof Dimensional Shingle
Construction	Frame
Foundation	Foundation Slab On Grade

School Information

Elementary	HOLLEY-NAVARRE
Middle	HOLLEY-NAVARRE

High NAVARRE

Additional Information

Zoning Residential Single Family

HOA Fees 0.00

Listing Details

Listing Office ERA American Real Estate

DISCLAIMER: Information Deemed Reliable but not guaranteed. The information being provided is for consumers' personal, non-commercial use and may not be used for any purpose other than to identify prospective properties consumers may be interested in purchasing. All listings are provided courtesy of the Emerald Coast Association of Realtors, Copyright 2024, All rights reserved. Vendors Member Number : 28325

Listing information last updated on July 23rd, 2024 at 9:15pm CDT