

\$482,950 - 9555 Creets Landing Dr CI48, NAVARRE

MLS® #957065

\$482,950

4 Bedroom, 3.00 Bathroom, 2,446 sqft
Detached Single Family on 0.00 Acres

CREETS LANDING, NAVARRE, FL

*This Popular Plan Features: 4 Bedrooms 3 Full Baths *3 CAR GARAGE * Covered Entry * Laminate flooring throughout Except Tile in Master Bath & Carpet in Bedrooms * Master Suite Features: Builder's Signature Zero Entry All Tile Walk in Shower, Separate Soaking Tub, Double Vanities & Huge Walk-in Closet *Kitchen Features: Granite Countertops, Large Island, White Shaker Style Cabinets, Stainless Steel Appliances & Walk in Pantry * Breakfast Cafe *Covered Rear Lanai * 2x6 Exterior Construction * Builder Warranty Included *

Built in 2024

Essential Information

MLS® #	957065
Price	\$482,950
Bedrooms	4
Bathrooms	3.00
Full Baths	3
Square Footage	2,446
Acres	0.00
Year Built	2024
Type	Detached Single Family
Sub-Type	Detached Single Family
Style	Craftsman Style
Status	Active

Community Information

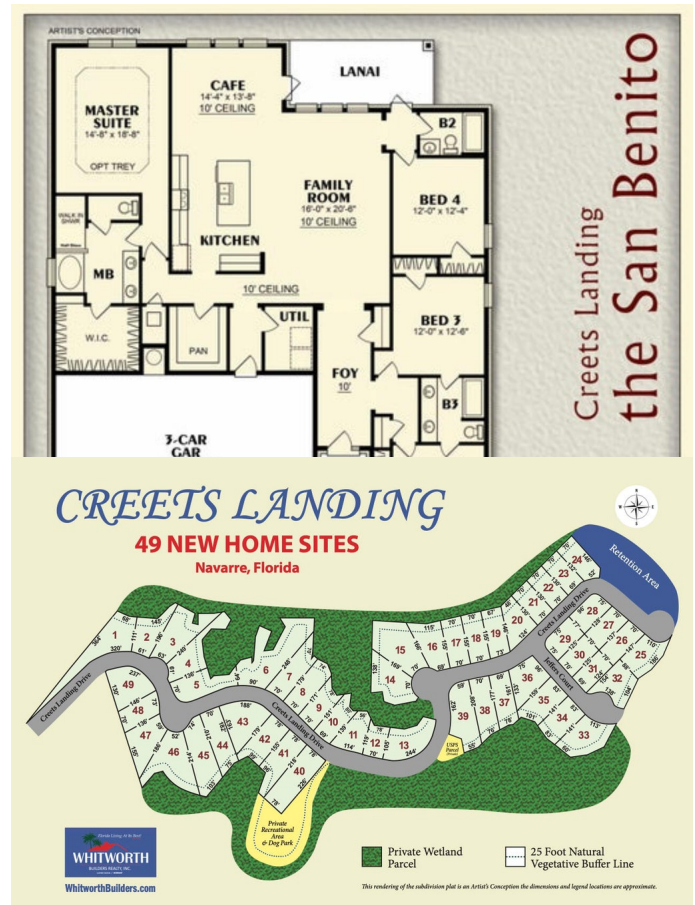

Address	9555 Creets Landing Dr Cl48
Area	Navarre/Gulf Breeze
Subdivision	CREETS LANDING
City	NAVARRE
County	SANTA ROSA
State	FL
Zip Code	32566

Amenities

Amenities	Pets Allowed
Utilities	Electric Available, Phone Available, Public Sewer Available, Public Water Available, Underground
Parking Spaces	3
Parking	Garage: Attached, Oversized
# of Garages	3
Pool	Community, Private

Interior

Interior Features	Floor Tile, Floor Vinyl, Kitchen Island, Lighting Recessed, Pantry, Pull Down Stairs, Split Bedroom, Washer/Dryer Hookup, Floor WW Carpet New
Appliances	Dishwasher, Disposal, Microwave, Oven:Self Cleaning, Smoke Detector, Smooth Stovetop Rnge, Stove/Oven Electric, Auto Garage Door Opn
Heating	Heat: Central Electric
Cooling	A/C: Central Electric, Ceiling Fans, A/C: High Efficiency
# of Stories	1

Exterior

Exterior	Siding Brick All, Roof Dimensional Shingle, Siding Vinyl, Foundation Slab On Grade, Trim Vinyl, Frame
Exterior Features	Columns, Patio Covered, Sprinkler System, Hurricane Shutters, Lawn Pump, Porch Covered
Lot Description	Corner, Covenants, Curb & Gutter, Easements, Restrictions
Windows	Double Paned Windows
Roof	Roof Dimensional Shingle
Construction	Frame
Foundation	Siding Vinyl, Foundation Slab On Grade

School Information

Elementary	HOLLEY-NAVARRE
------------	----------------

Middle	HOLLEY-NAVARRE
High	NAVARRE

Additional Information

Zoning	Residential Single Family, County, Deed Restriction
HOA Fees	600.00
HOA Fees Freq.	Annually

Listing Details

Listing Office	Whitworth Builders Realty Inc
----------------	-------------------------------

DISCLAIMER: Information Deemed Reliable but not guaranteed. The information being provided is for consumers' personal, non-commercial use and may not be used for any purpose other than to identify prospective properties consumers may be interested in purchasing. All listings are provided courtesy of the Emerald Coast Association of Realtors, Copyright2024, All rights reserved. Vendors Member Number : 28325
Listing information last updated on August 16th, 2024 at 1:15am CDT